

GREECE

AIRAC AIP SUPPLEMENT

MINISTRY OF INFRASTRUCTURE, TRANSPORT & NETWORKS

Phone: +30 210 9972480

CIVIL AVIATION AUTHORITY

FAX: +30 210 9750757

DIRECTORATE GENERAL OF AIR NAVIGATION SERVICE PROVIDER

AFTN: LGGYNYP

AERONAUTICAL INFORMATION SERVICE DIVISION

e-mail: hellas.ais@hcaa.gr
d20d@hcaa.gr

P.O.B. 70360 – GR 16610 GLYFADA
GREECE

01/2016

09 JUN 16

Effective date: **21 JUL 2016**

AD2-LGPA

New Aerodrome PAROS (LGPA) will be activated by NOTAM with the following characteristics

LGPA AD 2.1 AERODROME LOCATION INDICATOR AND NAME

LGPA - PAROS

LGPA AD 2.2 AERODROME GEOGRAPHICAL AND ADMINISTRATIVE DATA

1	ARP coordinates and site at AD	370115N 0250647 Centre of RWY
2	Direction and distance from (city)	8 KM S-SW from Paros Port
3	Elevation/Reference temperature	38 M (125 FT)/ 27° C
4	Geoid undulation at AD ELEV PSN	NIL
5	MAG VAR/Annual change	4°04'E (4.07°) (JAN 2016)/ 5'30"E (0.092°E)
6	AD Administration, address, telephone, telefax, telex, AFS	Civil Aviation Authority (CAA) Paros Airport GR 84400 PAROS TEL: +30 22840 90900 FAX: +30 22840 91077 TLX: +293162 LGPA AFTN: LGPAYDYX
7	Types of traffic permitted (IFR/VFR)	IFR - VFR
8	Remarks	NIL

LGPA AD 2.3 OPERATIONAL HOURS

1	AD Administration	HO
2	Customs and immigration	NIL
3	Health and sanitation	NIL
4	AIS Briefing Office	HO
5	ATS Reporting Office (ARO)	HO
6	MET Briefing Office	HO ()
7	ATS	HO
8	Fuelling	NIL
9	Handling	HO
10	Security	HO
11	De-icing	NIL
12	Remarks	NIL

LGPA AD 2.4 HANDLING SERVICES AND FACILITIES

1	Cargo-handling facilities	NIL
2	Fuel/oil types	Fuel: NIL Oil: NIL
3	Fuelling facilities/capacity	NIL
4	De-icing facilities	NIL
5	Hangar space for visiting aircraft	NIL
6	Repair facilities for visiting aircraft	NIL
7	Remarks	NIL

LGPA AD 2.5 PASSENGER FACILITIES

1	Hotels	At Paros town.
2	Restaurants	At Paros town.
3	Transportation	Taxis and Bus.
4	Medical facilities	Medical Centre at At Paros town.
5	Bank and Post Office	At Paros town.
6	Tourist Office	NIL
7	Remarks	NIL

LGPA AD 2.6 RESCUE AND FIRE FIGHTING SERVICES

1	AD category for fire fighting	CIV CAT: 6
2	Rescue equipment	Equivalent for CAT 6 requirements.
3	Capability for removal of disabled aircraft	NIL
4	Remarks	NIL

LGPA AD 2.7 SEASONAL AVAILABILITY - CLEARING

1	Types of clearing equipment	NIL
2	Clearance priorities	NIL
3	Remarks	All seasons.

LGPA AD 2.8 APRONS, TAXIWAYS AND CHECK LOCATIONS/POSITIONS DATA

1	Apron surface and strength	Surface: asphalt Strength: PCN 49/F/B/Y/T
2	Taxiway width, surface and strength	Width: 23M Surface: asphalt Strength: PCN 49/F/B/Y/T
3	Altimeter checkpoint location and elevation	NIL
4	VOR checkpoints	NIL
5	INS checkpoints	NIL
6	Remarks	NIL

LGPA AD 2.9 SURFACE MOVEMENT GUIDANCE AND CONTROL SYSTEM AND MARKINGS

1	Use of aircraft stand ID signs, TWY guide lines and visual docking/parking guidance system of aircraft stands	NIL
2	RWY and TWY markings and LGT	LGT: RWY 17: Threshold, edge, end, RTIL RWY 35: Threshold, edge, end, RTIL TWY: Edge Markings: RWY: THR, designations, centre line, side stripes, touch down zones, fixed distance, turnpad marking. TWY: Centre line, holding position.
3	Stop bars	NIL
4	Remarks	Guidance on the apron by marshaller.

LGPA AD 2.10 AERODROME OBSTACLES

In approach/TKOF areas			In circling area and at AD		Remarks
1			2		
RWY NR/Area affected	Obstacle type Elevation Markings/LGT	Coordinates	Obstacle type Elevation Markings/LGT	Coordinates	3
a	b	c	a	b	
17	NIL		Not available		
35	NIL		Not available		

LGPA AD 2.11 METEOROLOGICAL INFORMATION PROVIDED

1	Associated MET Office	PAROS
2	Hours of service MET Office outside hours	HO ATHINAI
3	Office responsible for TAF preparation Period of validity	ATHINAI 9 HR PRIOR TO DOMESTIC FLIGHTS
4	Trend forecast Interval of issuance	NO TREND
5	Briefing/consultation provided	Personal consultation, Telephone.
6	Flight documentation Language(s) used	Charts, Tabular forms Greek, English
7	Charts and other information available for briefing or consultation	P ₇₀ , P ₅₀ , P ₄₀ , P ₃₀ SWH, SWM, SWL
8	Supplementary equipment available for providing information	On line data connection to the data Bank of the Hellenic National Meteorological Service.
9	ATS units provided with information	PAROS AFIS, ATHINAI ACC
10	Additional information (limitation of service, etc.)	All data over FL 50 are issued by World Area Forecast Centre London. TEL & FAX: +30 22840 91485, TLX: 0293373

LGPA AD 2.12 RUNWAY PHYSICAL CHARACTERISTICS

Designations RWY NR	TRUE BRG (degrees and minutes)	Dimensions of RWY (M)	Strength (PCN) and surface of RWY and SWY	THR coordinates RWY end coordinates THR geoid undulation	THR elevation and highest elevation of TDZ of precision APP RWY
1	2	3	4	5	6
17	169° 12'	1400 x 30	PCN 49/F/B/Y/T asphalt	370137.81N 0250641.72E 370053.18N 0250652.33E 37.60 M	THR 36.29 M / 119.03 FT TDZ: NIL
35	349° 12'	1400 x 30	PCN 49/F/B/Y/T asphalt	370053.18N 0250652.33E 370137.81N 0250641.72E 37.57 M	THR 32.08 M / 105.22 FT TDZ: NIL

Slope of RWY-SWY			SWY dimensions (M)	CWY dimensions (M)	Strip dimensions (M)	OFZ	Remarks
7			8	9	10	11	12
17	+0.44%/-0.69% 480M/920M	N/ A	N/A	300X150	1520 x 150 M	N/A	See relevant LGPA-ADC and AOC chart-ICAO
35	+0.69%/-0.44% 920M/480M	N/ A	N/A	300X150	1520 x 150 M	N/A	

LGPA AD 2.13 DECLARED DISTANCES

RWY Designator	TORA (M)	TODA (M)	ASDA (M)	LDA (M)	Remarks
1	2	3	4	5	6
17	1400	1700	1400	1400	RESA 240X150
35	1400	1700	1400	1400	RESA 240X150

LGPA AD 2.14 APPROACH AND RUNWAY LIGHTING

RWY Designator	APCH LGT Type Length Intensity	THR LGT Colour Wingbars	PAPI VASIS Angle Distance from THR (MEHT)	TDZ, LGT Length	RWY Centre- line LGT Length Spacing, Colour Intensity	RWY edge LGT Length Spacing Colour Intensity	RWY End LGT Colour Wingbars	SWY LGT Length Colour	Remarks
1	2	3	4	5	6	7	8	9	10
17	NIL	GREEN RTIL	APAPI LEFT/3° 245 m MEHT 12.8 M	NIL	NIL	WHITE LIM	RED	NIL	See also LGPA AD chart-ICAO.
35	NIL	GREEN RTIL	APAPI LEFT/ 3° 232 m MEHT 12.8 M	NIL	NIL	WHITE LIM	RED	NIL	

LGPA AD 2.15 OTHER LIGHTING, SECONDARY POWER SUPPLY

1	ABN/IBN location, characteristics and operational hours	ABN: NIL IBN: NIL
2	LDI location and LGT Anemometer location and LGT	LDI: WDI: On both sides of RWY, lighted. Anemometer:
3	TWY edge and centre line lighting	Edge: Blue Centre Line: NIL
4	Secondary power supply/switch-over time	Available
5	Remarks	Apron: Flood lights.

LGPA AD 2.16 HELICOPTER LANDING AREA

1	Coordinates TLOF or THR of FATO Geoid undulation	NIL
2	TLOF and/or FATO elevation M/FT	NIL
3	TLOF and FATO area dimensions, surface, strength, marking	NIL
4	True BRG of FATO	NIL
5	Declared distance available	NIL
6	APP and FATO lighting	NIL
7	Remarks	See LGPA AD 2.20.4

LGPA AD 2.17 ATS AIRSPACE

1	Designation and lateral limits	PAROS CTR a) 365400N 0245400E b) 370000N 0244900E c) 371800N 0244900E d) 371330N 0251100E Last (d) and first (a) points are joined by an arc of circle 13 NM radius center at (370037N 0250741E)
		PAROS ATZ Circle, 5 NM radius centered at 370037N 0250741E.
2	Vertical limits	CTR: SFC to 8500 FT ALT ATZ: SFC to 2000 FT ALT
		CTR: SFC to 8500 FT ALT ATZ: SFC to 2000 FT ALT
3	Airspace classification	NIL
4	ATS unit call sign Language(s)	CTR : ATHINAI CONTROL Greek, English
		ATZ : PAROS INFORMATION Greek, English
5	Transition altitude	4000 FT
6	Remarks	NIL

LGPA AD 2.18 ATS COMMUNICATION FACILITIES

Service designation	Call sign	Frequency/ VHF CH	Operational hours	Remarks
1	2	3	4	5
AFIS	PAROS INFORMATION	125.050 121.500	HO HO	Primary freq Coverage FL 30 / 15 NM Emergency
G/A/G	PAROS RADIO	5637 kHz 2989 kHz	HO: 0400 – 1700 HO: 1700 - 0400	Primary freq. Primary freq.
All ATS Communication Facilities under responsibility of CAA.				

LGPA AD 2.19 RADIO NAVIGATION AND LANDING AIDS

Type of aid MAG VAR CAT of ILS/MLS (For VOR/ILS/MLS, give declination)	ID	Frequency (CH)	Hours of operation	Position of transmitting antenna coordinates	Elevation of DME transmitting antenna (Ft aMSL)	Remarks
1	2	3	4	5	6	7
PAROS L (4°E / 2016)	PAO	386 kHz	H24	370041.57N 0250744.68E	-	Coverage 25 NM

All Radio Navigation and Landing Aids under responsibility of CAA.
See also **GEN 2.5**

LGPA AD 2.20 LOCAL TRAFFIC REGULATIONS

2.20.1 Airport regulations

NIL

2.20.2 Taxiing to and from stands

NIL

2.20.3 Parking area for small aircraft (General aviation)

NIL

2.20.4 Parking area for helicopters

2.20.4.1 An area in the Apron, which depending on Aerodrome traffic and parking availability, is specified each time by the AD operator.

2.20.5 Apron - taxiing during winter conditions

NIL

2.20.6 Taxiing – limitations

NIL

2.20.7 School and training flights - technical test flights - use of runways

NIL

2.20.8 Helicopter traffic – limitation

NIL

2.20.9 Removal of disabled aircraft from runways

NIL

LGPA AD 2.21 NOISE ABATEMENT PROCEDURES

Part I

2.21.1 Noise abatement procedures for jet aeroplanes irrespective of weight, and for propeller and turboprop aeroplanes with MTOM of or above 11 000 KG

2.21.1.1 General provisions

NIL

2.21.1.2 Use of the runway system during the day period 0600-2200 (0500-2100)

NIL

2.21.1.3 Use of the runway system during the night period 2200-0600 (2100-0500)

NIL

2.21.1.4 Restrictions

NIL

2.21.1.5 Reporting

NIL

Part II

2.21.2 Noise abatement procedures for propeller and turboprop aeroplanes with MTOM below 11 000 KG

2.21.2.1 Use of the runway system during the day period 0600-2300 (0500-2200)

NIL

2.21.2.2 Use of the runway system during the night period 2300-0600 (2200-0500)

NIL

2.21.2.3 Reporting

NIL

Part III

2.21.3 Noise abatement procedures for helicopters

2.21.3.1 General provisions

NIL

2.21.3.2 Use of the runway system during the day period 0600-2300 (0500-2200)

NIL

2.21.3.3 Use of the runway system during the night period 2300-0600 (local time)

NIL

2.21.3.4 Reporting

NIL

LGPA AD 2.22 FLIGHT PROCEDURES

- 2.22.1 General**

- 2.22.2 Runway in use**
 - 2.22.2.1 RWY 17/35
- 2.22.3 Procedures for IFR flights within TMA**
- 2.22.4 Radar procedures within TMA**
- NIL
- 2.22.5 Procedures for VFR flights within TMA**
- 2.22.6 Procedures for VFR flights within CTR**
- 2.22.7 Standard instrument departure procedure (SID)**

LGPA AD 2.23 ADDITIONAL INFORMATION

- 2.23.1 Bird concentrations in the vicinity of the airport**
 - 2.23.1.1 No significant concentration of birds on and at the vicinity of airport during daylight hours. See also ENR 5.6.

LGPA AD 2.24 CHARTS RELATED TO AERODROME

Chart name	Date	Page
Aerodrome Chart – ICAO: -	21 JUL 2016	AD 2-LGPA-ADC
Aircraft Parking/ Docking Chart – ICAO: -	NIL	NIL
Aerodrome Obstacle Chart (AOC) - ICAO, Type A: -	21 JUL 2016	AD 2-LGPA-AOC A
Aerodrome Obstacle Chart (AOC) – ICAO, Type B: -	NIL	NIL
Precision Approach Terrain Chart – ICAO: -	NIL	NIL
Instrument Approach Chart (IAC) – ICAO: -	NIL	NIL
Standard Departure Chart - Instrument (SID) – ICAO: - RWY 35	NIL	NIL
Standard Departure Chart - Instrument (SID) – ICAO: - RWY 17	NIL	NIL
Standard Arrival Chart - Instrument (STAR) – ICAO: -	NIL	NIL
Terminal Area Chart - ICAO - VFR routes: -	NIL	NIL
TAR System Coverage Chart – VEC area: -	NIL	NIL

AERODROME CHART-ICAO

ARP 370115N 0250647E
AD ELEV 38.39 M / 125.92 FT

PAROS / PAROS Airport

Lighting Aids	
Runway Lighting	Edge, Threshold, End, RTIL.
Other Lighting	TWY Edge (blue), Apron floodlights. Blue turning circle lights on both runways.
Approach Lighting	NIL.

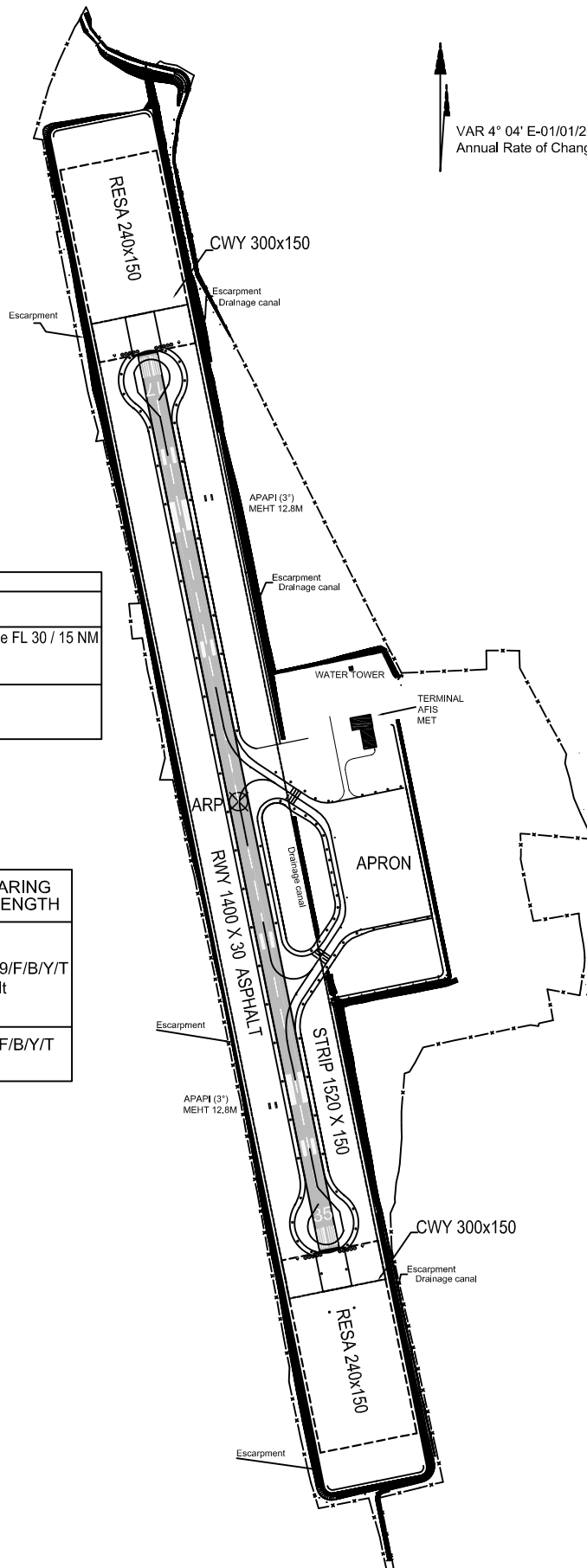

VAR 4° 04' E-01/01/2016
Annual Rate of Change 5' 30" E

ATS COMMUNICATION FACILITIES				
Service Designation	Call Sign	Frequency	Operational hours	Remarks
AFIS	PAROS INFORMATION	125.050 MHZ	HO	Primary freq. Coverage FL 30 / 15 NM
		121.500 MHZ	HO	Emergency
G/A/G	PAROS RADIO	5637 KHZ 2989 KHZ	HO: 0400 - 1700 HO: 1700 - 0400	Primary freq. Primary freq.

RWY	DIRECTION	THRESHOLD	THR Elevation (AMSL) GUND Elevation	BEARING STRENGTH
17	165°	370137.81N	36.29	PCN 49/F/B/Y/T Asphalt
		0250641.72E	37.60	
35	345°	370053.18N	32.08	PCN 49/F/B/Y/T Asphalt
		0250652.33E	37.57	

Twys-Aprons, type of surface - Bearing strength: Asphalt - PCN 49/F/B/Y/T

SCALE 1 : 10000

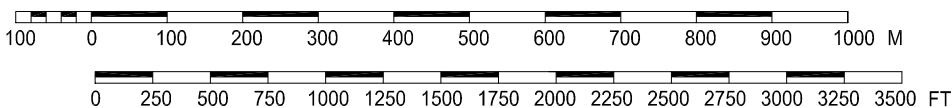

VAR 4° 04' E-01/01/2016
 Annual Rate of Change 5' 30" E

RWY 17 - 35

DECLARED DISTANCES		
RWY 17		RWY 35
1400	TAKE OFF RUN AVAILABLE	1400
1400	ACCELERATE STOP DISTANCE AVAILABLE	1400
1700	TAKE OFF DISTANCE AVAILABLE	1700
1400	LANDING DISTANCE AVAILABLE	1400

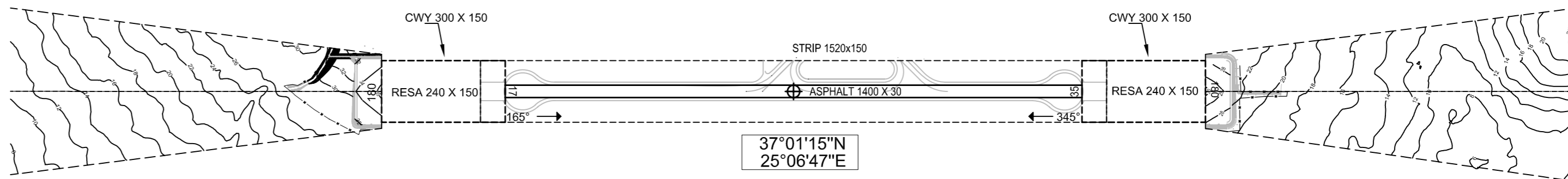
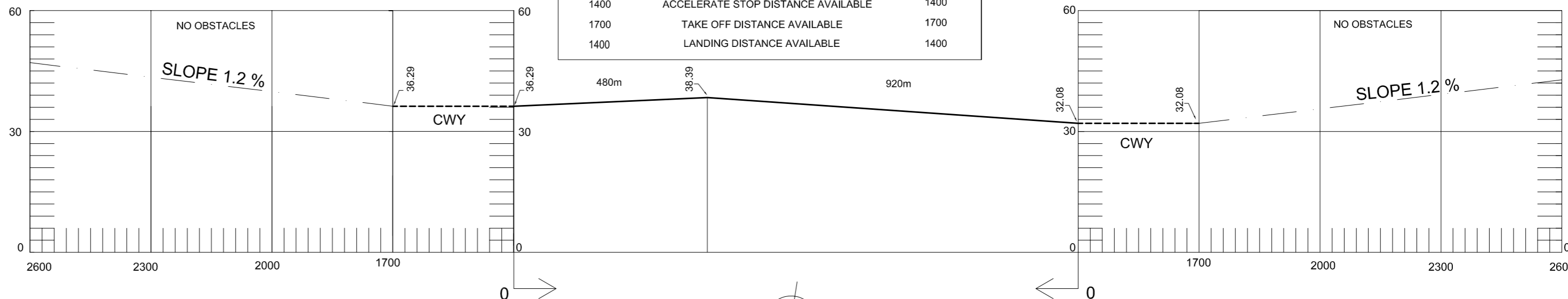
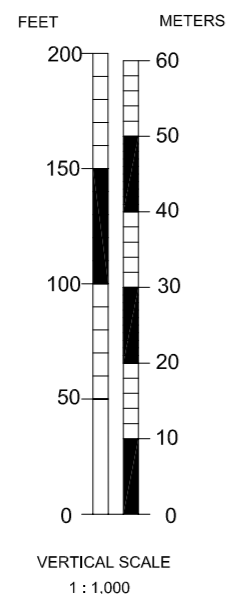

LEGEND	PLAN	PROFILE
Identification number	①	①
Obstructions within the take-off flight path area		┆
Obstructions beyond the take-off flight path area		┆
Spot elevation	5.3	
Tree or shrub	✕	
Transmission line - overhead cable	T	
Road	══	
Fence	- - - -	
Building or large structure	■	
Terrain penetrating obstruction plane	●	◐
Pole, tower, spire, antenna, chimney	⊙	

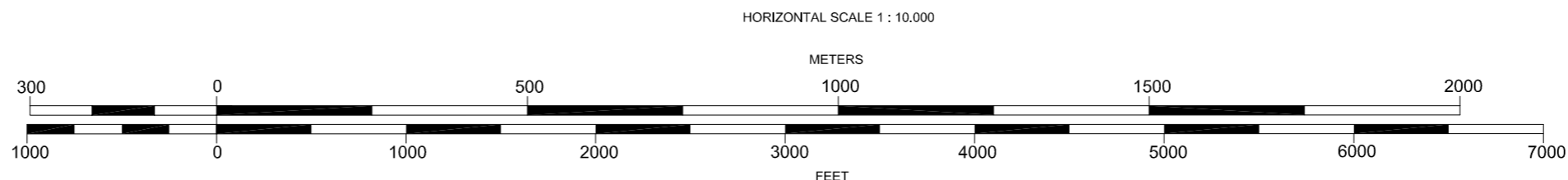

AMENDMENT RECORD		
No.	DATE	ENTERED BY